

BUSBAR SUPPORTS

- LV STANDOFF INSULATORS FOR BUSBARS

Crompton Greaves manufactures a range of busbar supports with octagonal centreband to compliment their range of switchboard and control panel accessories. These insulators are moulded from high electrical grade, red Polyester Reinforced Resin (DMC), fitted with brass inserts and are offered at very competitive prices with no compromise of quality.

CAT NO.	Ø A	B	C	D	INSERT
1030EN	25	32	30	8	M6
1035EN	25	32	35	9	M6
1035FN	25	32	35	9	M8
1038GN	35	40	38	10	M10
1040EN	35	40	40	10	M6
1040FN	35	40	40	10	M8
1050FN	31	41	50	10	M8
1050GN	31	41	50	10	M10
1050HN	31	41	50	10	M12
1060GN	40	55	60	11	M10
1060HN	40	55	60	11	M12

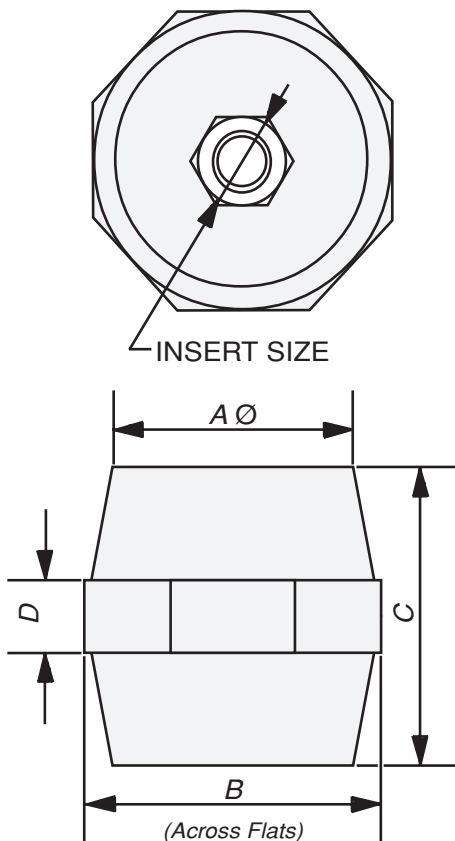

PROPERTIES	UNIT	TEST METHOD	VALUE
			DMC
PHYSICAL			
Specific Gravity	g/cc		1.80
Glass Content	%		20
Water Absorption	%		0.20
MECHANICAL			
Tensile Strength	kg/cm ²	BS 2782	1200
Flexural/Cross Breaking Strength	kg/cm ²	BS 2782	550
Compressive Strength	kg/cm ²	BS 2782	1450
Impact Strength - Izod	kg/cm ²	BS 2782	35
ELECTRICAL			
Dielectric Strength	kV/mm	BS 2782	13
Tracking Index	V	BS 5901	1000
Arc Resistance	Seconds	BS 2782	220
Heat Distortion	°C	DIN 53458	150
Flammability		ASTM D495	SE